

R02 Series

Single / Double Threshold Rolling Door

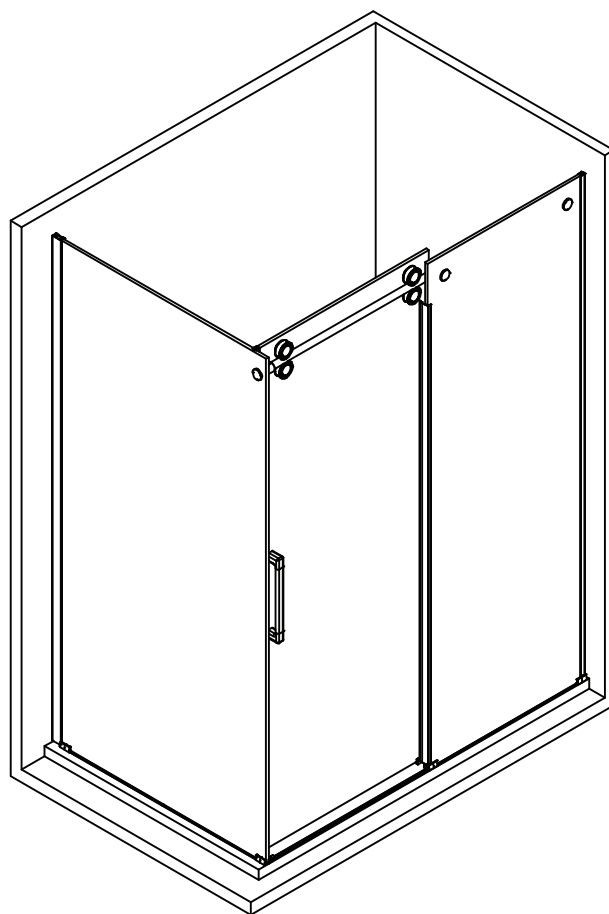
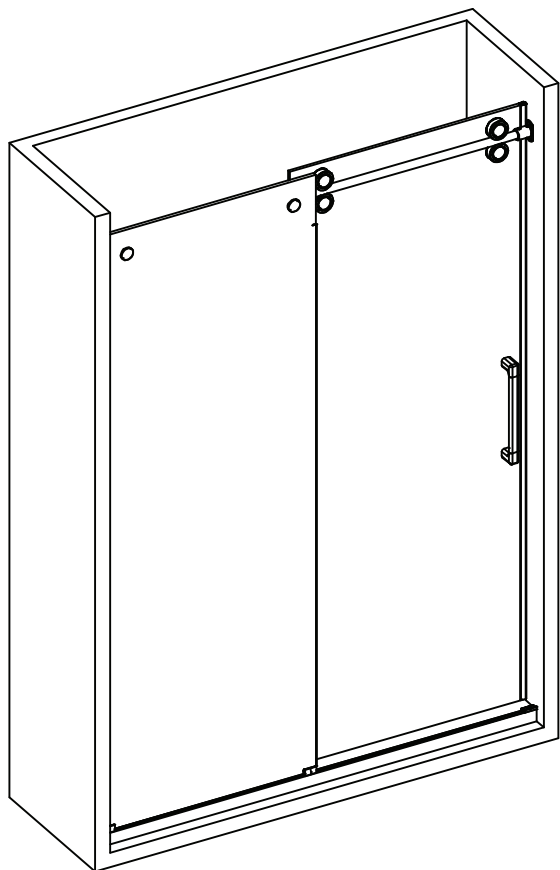

Updated: 2022/01/07

INSTALLATION MANUAL

IMPORTANT

- Thoroughly inspect your product before proceeding with the installation.
- The warranty will be void if the product is installed with a conspicuous defect.

CAUTION

- To prevent leaks, silicone must be applied on the outside of the shower and not on the inside!
- Read all instructions carefully before starting the installation.
- Save this manual for future reference.

PARTS LIST

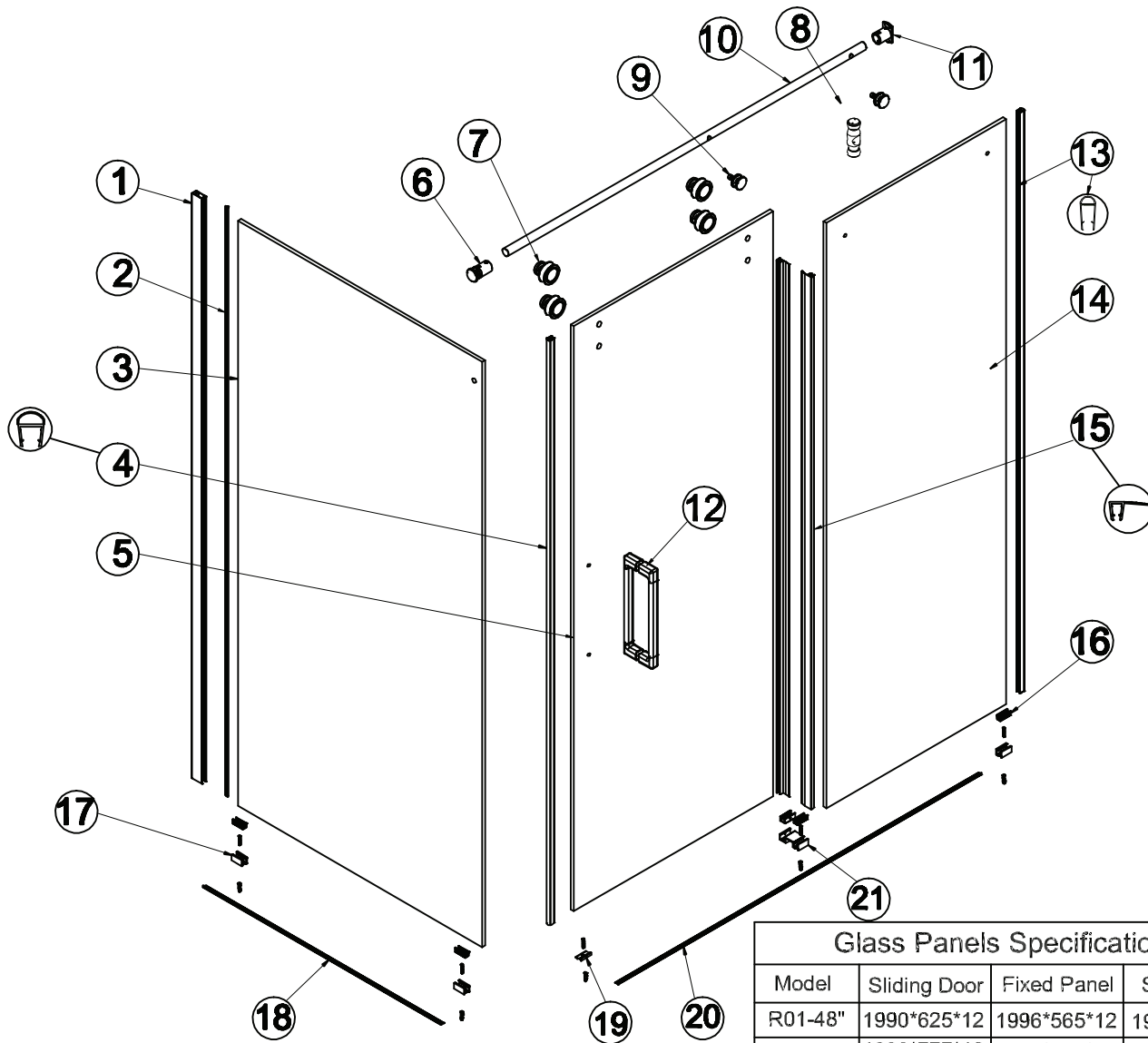

Glass Panels Specifications

Model	Sliding Door	Fixed Panel	Side Panel
R01-48"	1990*625*12	1996*565*12	1996*748*12
R01-60"	1990*777*12	1996*717*12	1996*848*12

No.	Description	Specification	Quantity
1	Wall Jamb	2000mm	1
2	4.0 Glazing Gasket	2000mm	1
3	Side Panel	See Chart Above	1
4	Anti-bumping Gasket	1990mm	1
5	Sliding Panel	See Chart Above	1
6	Glass Mount Bracket	Stainless Steel	1
7	Roller	Stainless Steel	4
8	Stopper	Stainless Steel	1
9	Glass Holder	Stainless Steel	2
10	Rail	1419mm	1
11	Wall Mount Bracket	Stainless Steel	1
12	Handle	Stainless Steel	1
13	Bubble Gasket	2010mm	1
14	Fixed Panel	See Chart Above	1
15	Door Sweep Gasket	2000mm	2
16	Glass Clip Gasket	1.6"(40mm)	1

COMPONENT LIST

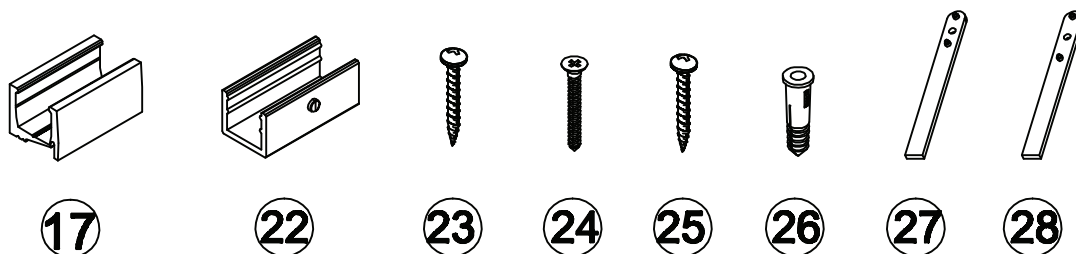

No.	Description	Specification	Quantity
17	Bottom Glass Clip	1.6"(40mm)	2
18	Aluminium Threshold		1
19	Tall Threshold	1.6"(40mm)	1
20	Aluminium Threshold		1
21	Bottom Guide	1.6"(40mm)	1
22	Bottom Guide Gasket		1
23	Pan Head Screw	1.6"(40mm)	6
24	Truss Head Screw	1.6"(40mm)	11
25	Round Head Screw	1.6"(40mm)	4
26	Wall Anchor	Ø6 Yellow	17
27	Installation Tool		1
28	Roller Tool		1

Please note: Carefully read all instructions before proceeding with installation. MTI recommends using a professional installer. All gaskets and thresholds may be trimmed to fit.

TOOLS AND MATERIALS REQUIRED



SCREWDRIVERS

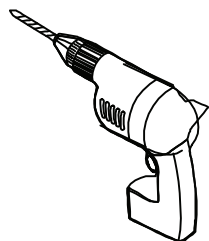

DRILL

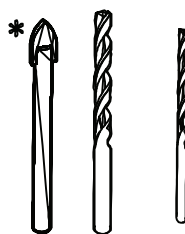

1/4" & 1/8" DRILL BITS

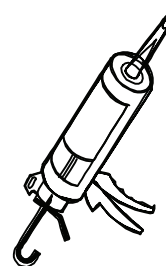

SILICONE

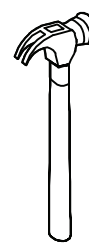

HAMMER

** If the shower panels are to be assembled on ceramic tiles, use a 1/4" drill bit for ceramic tiles.*



PENCIL

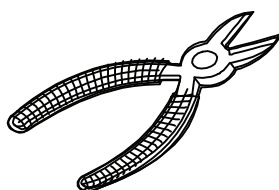

CUTTING PLIER

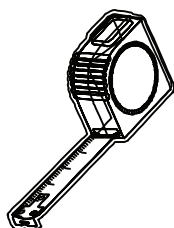

TAPE MEASURE



MALLET

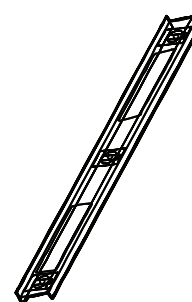

LEVEL



ALLEN WRENCH

1.

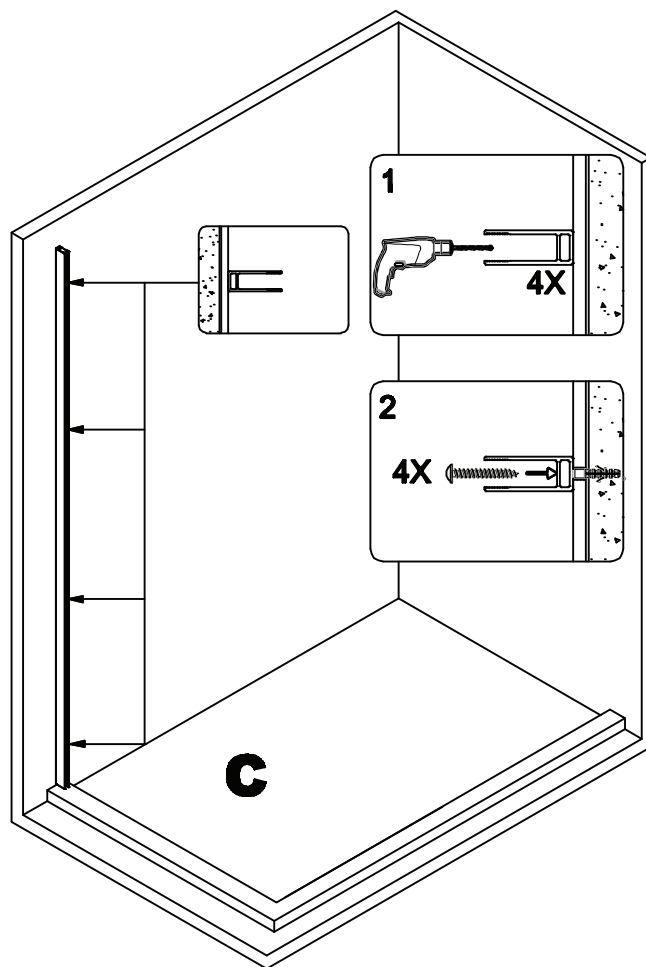
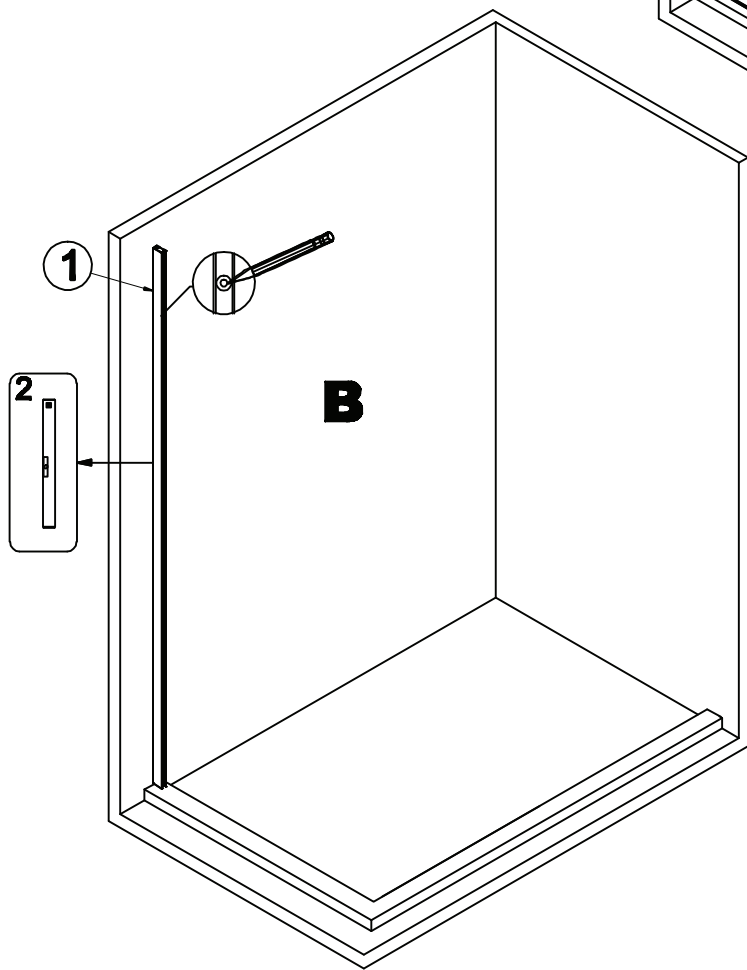
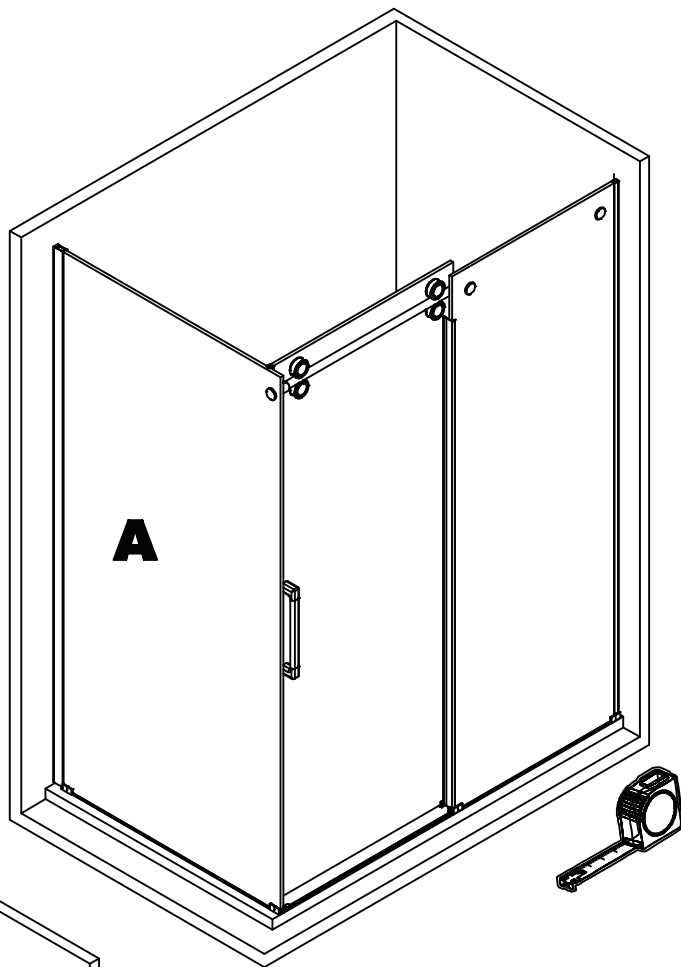

2.

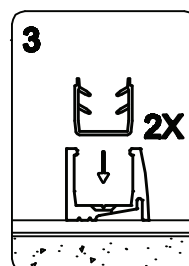
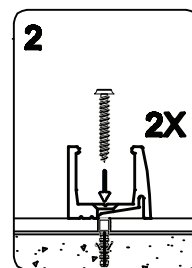
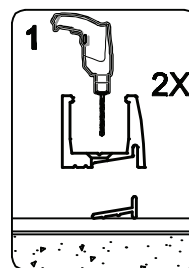
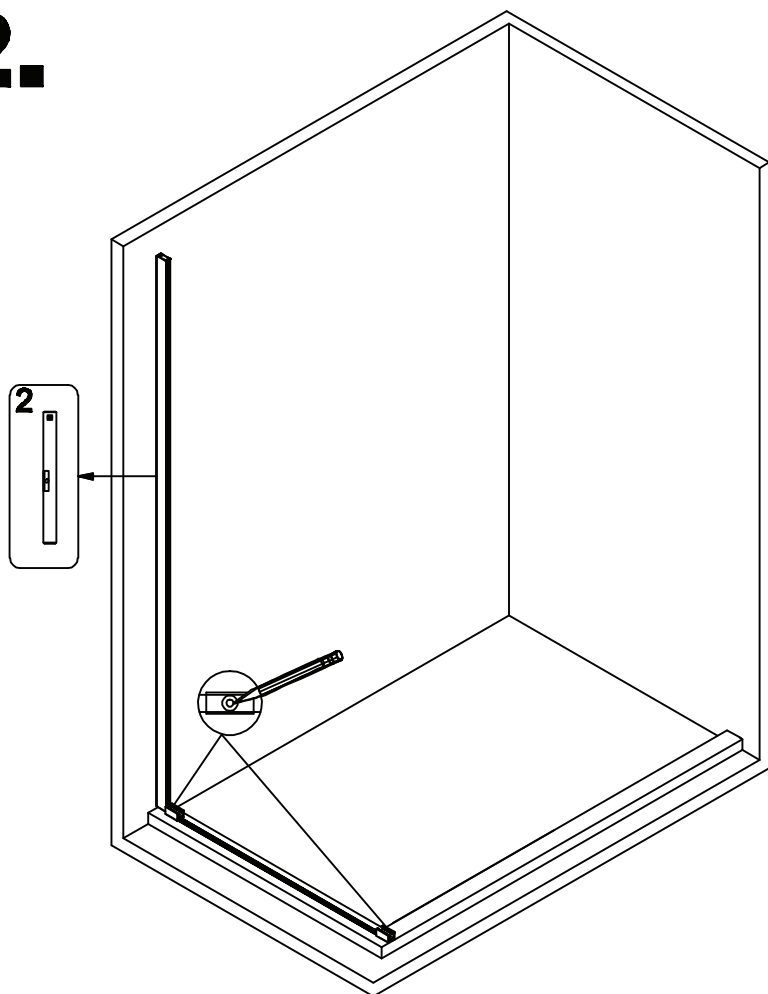

3.

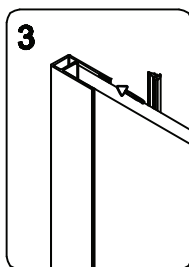
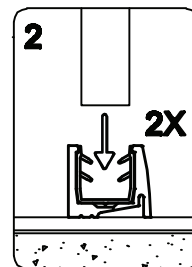
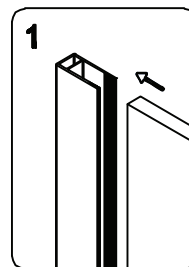
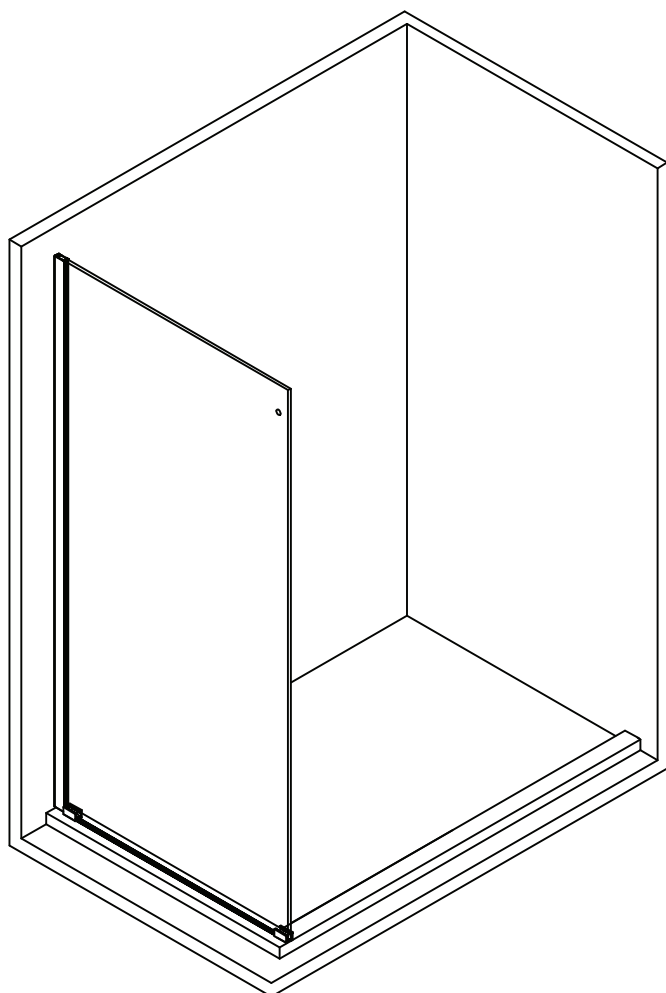

4.

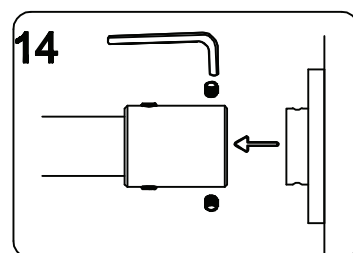
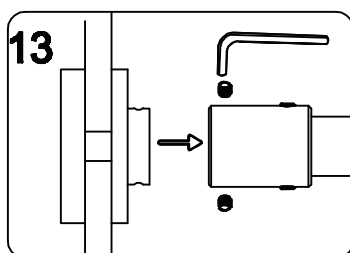
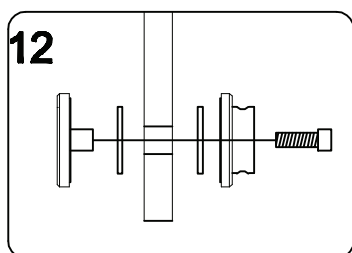
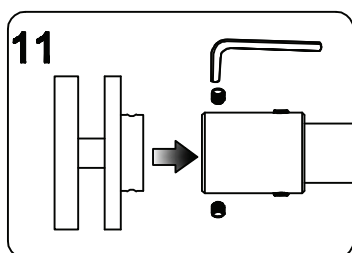
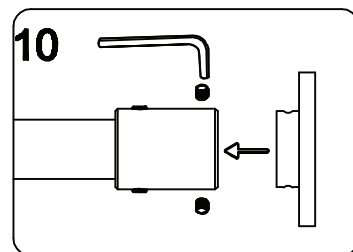
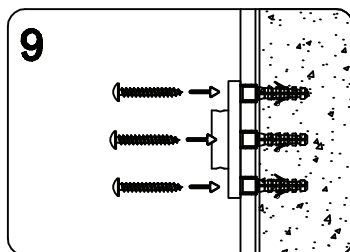
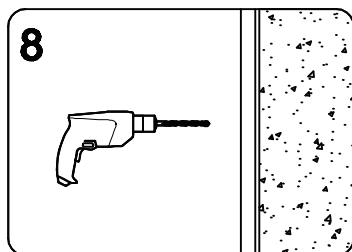
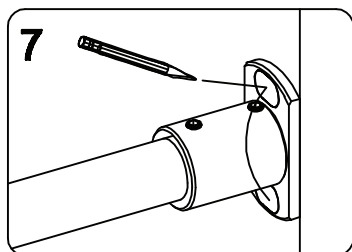
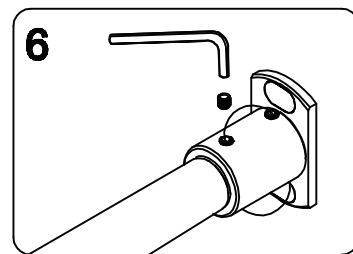
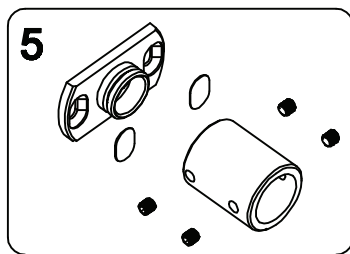
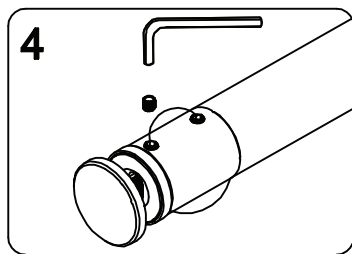
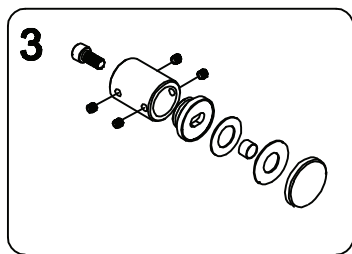
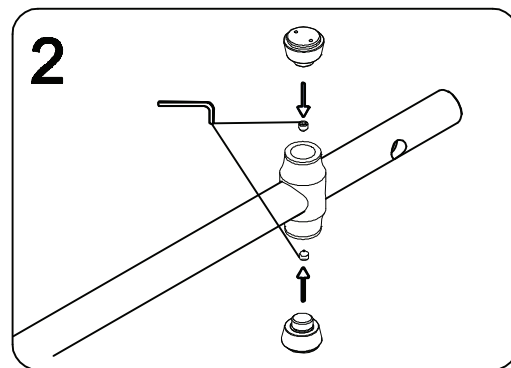
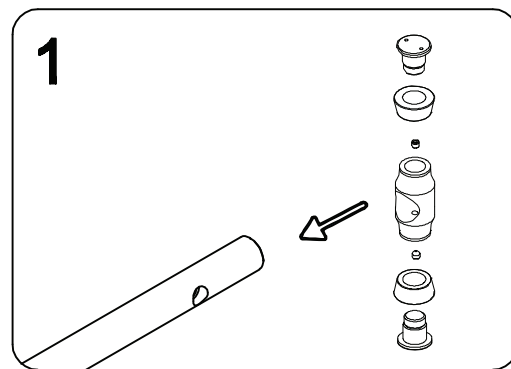
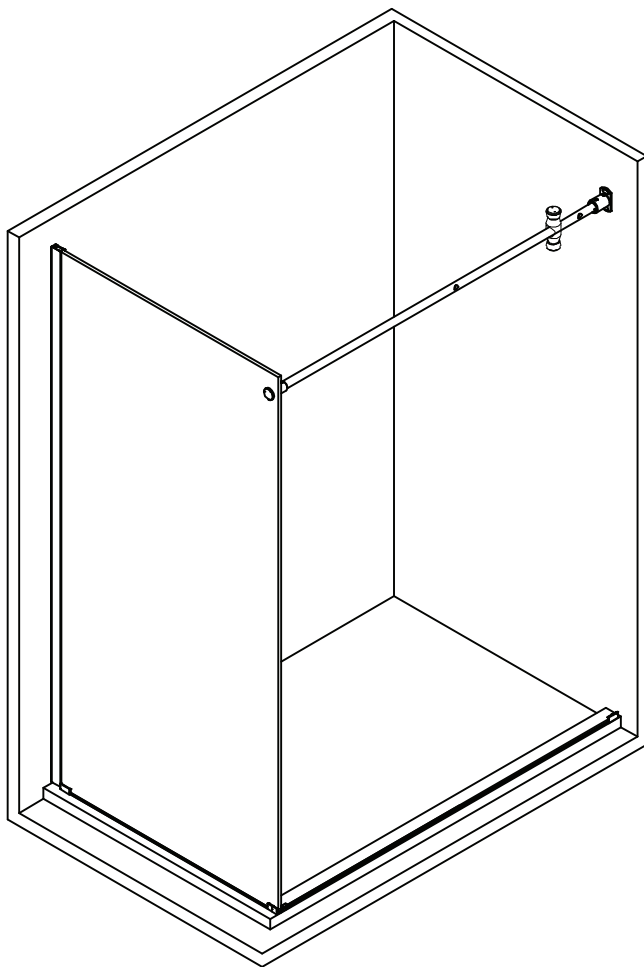

5.

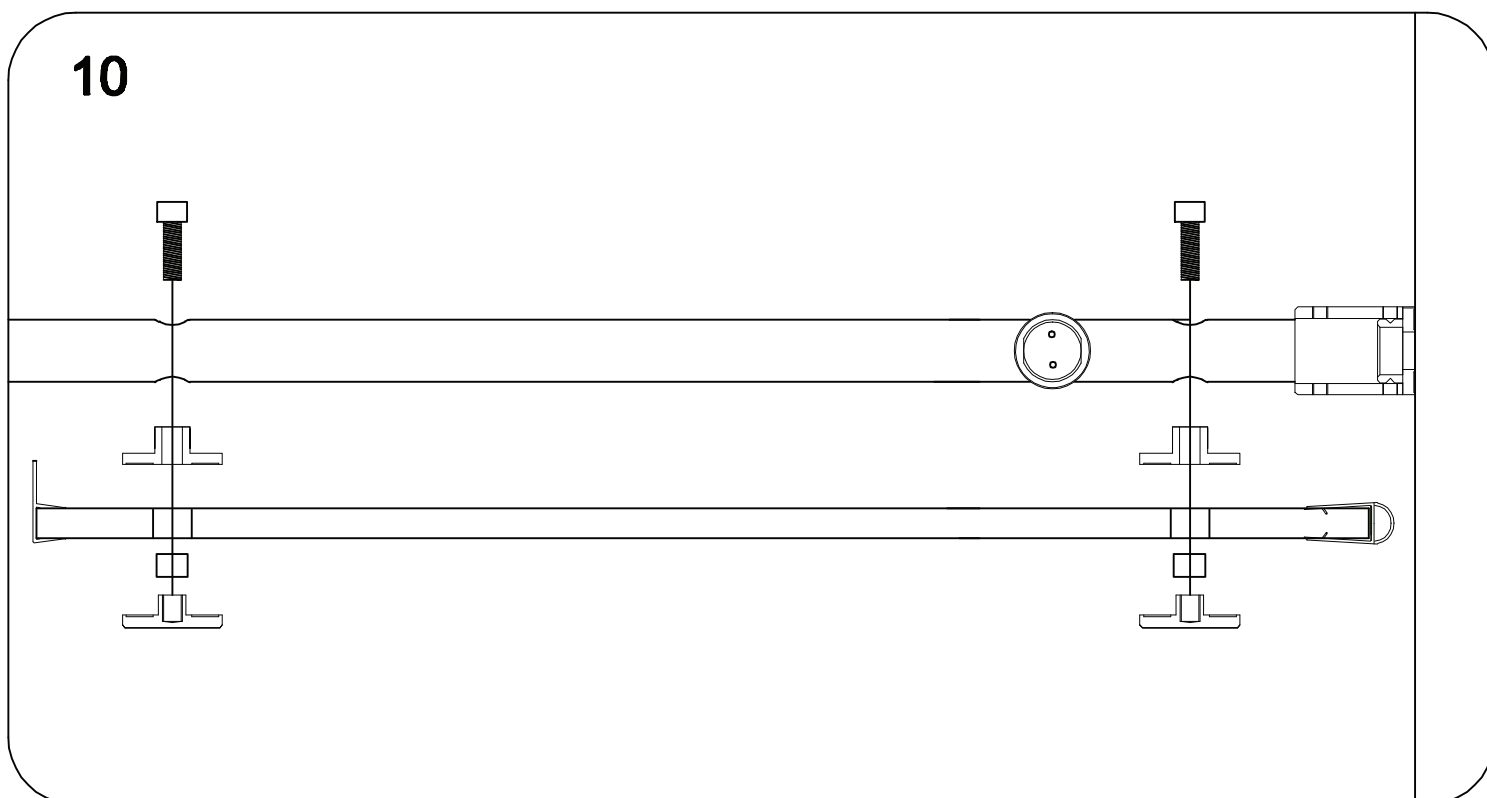
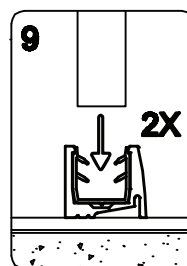
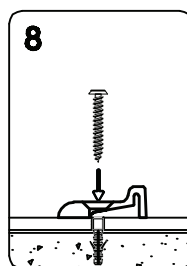
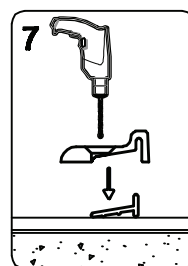
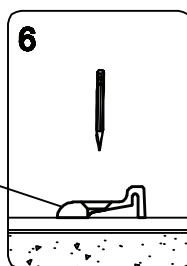
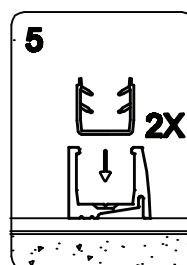
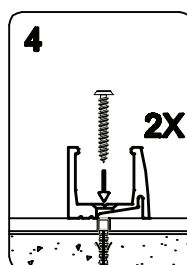
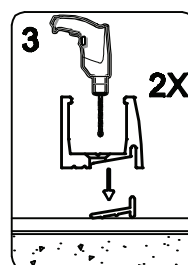
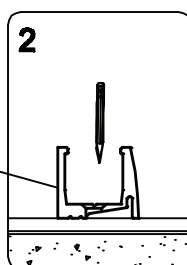
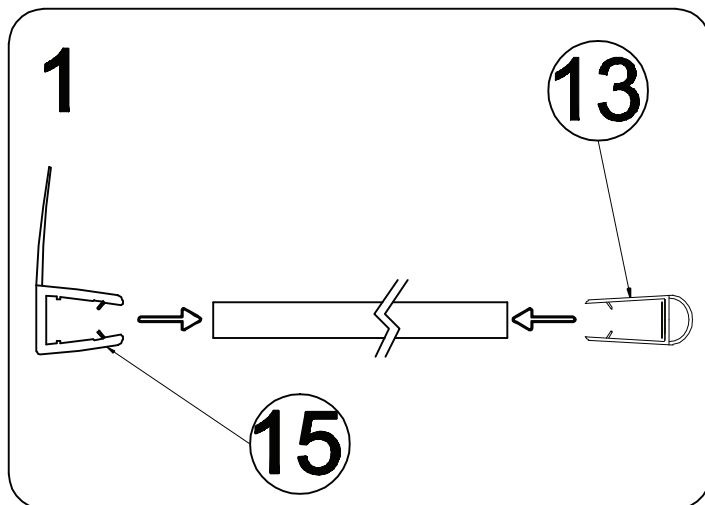
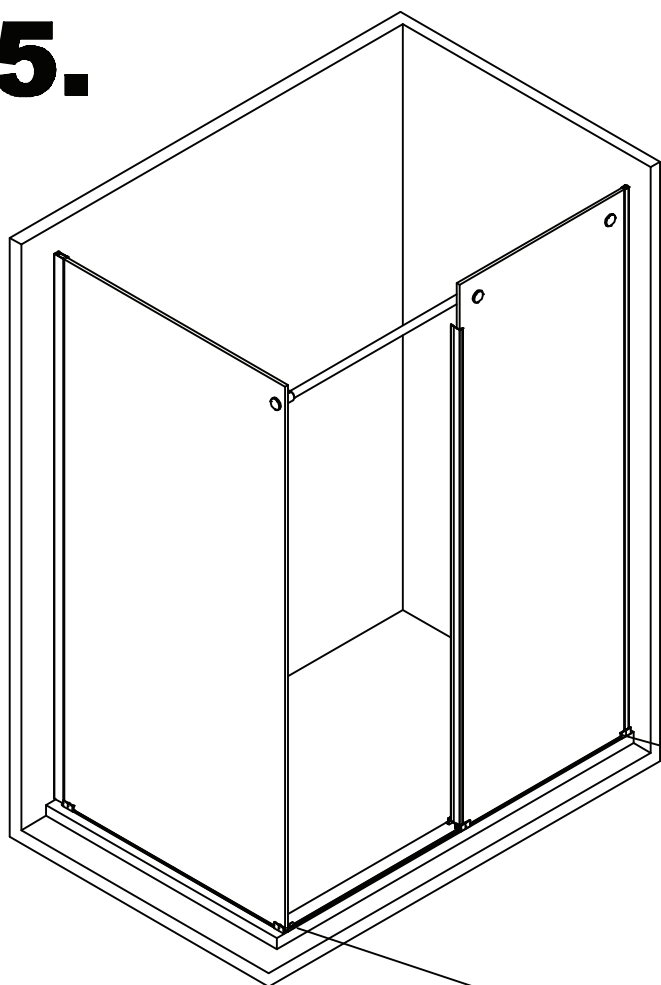

6.

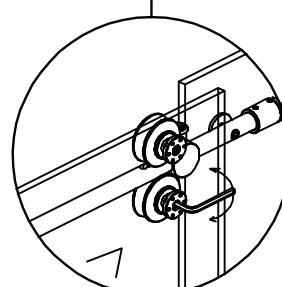
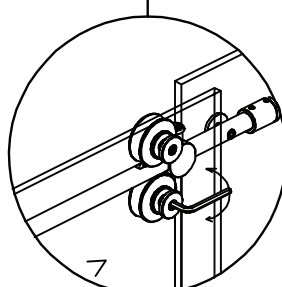
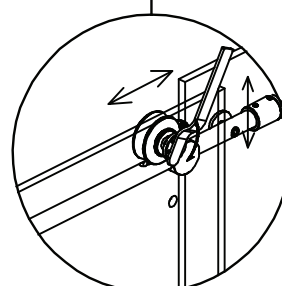
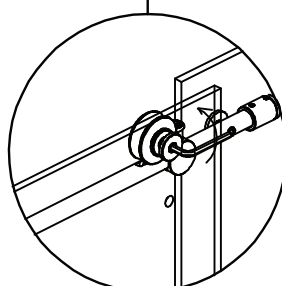
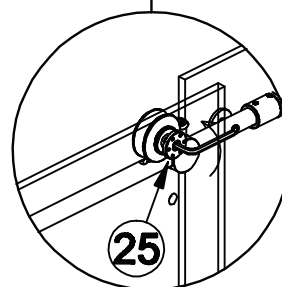
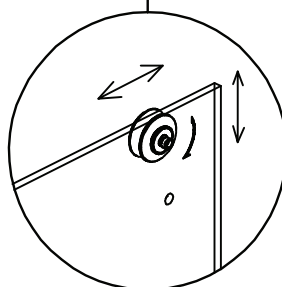
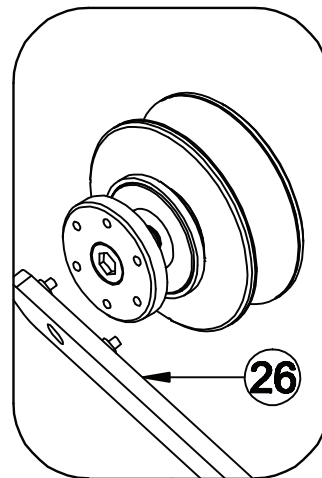
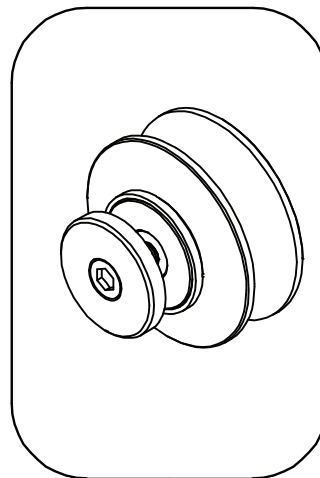
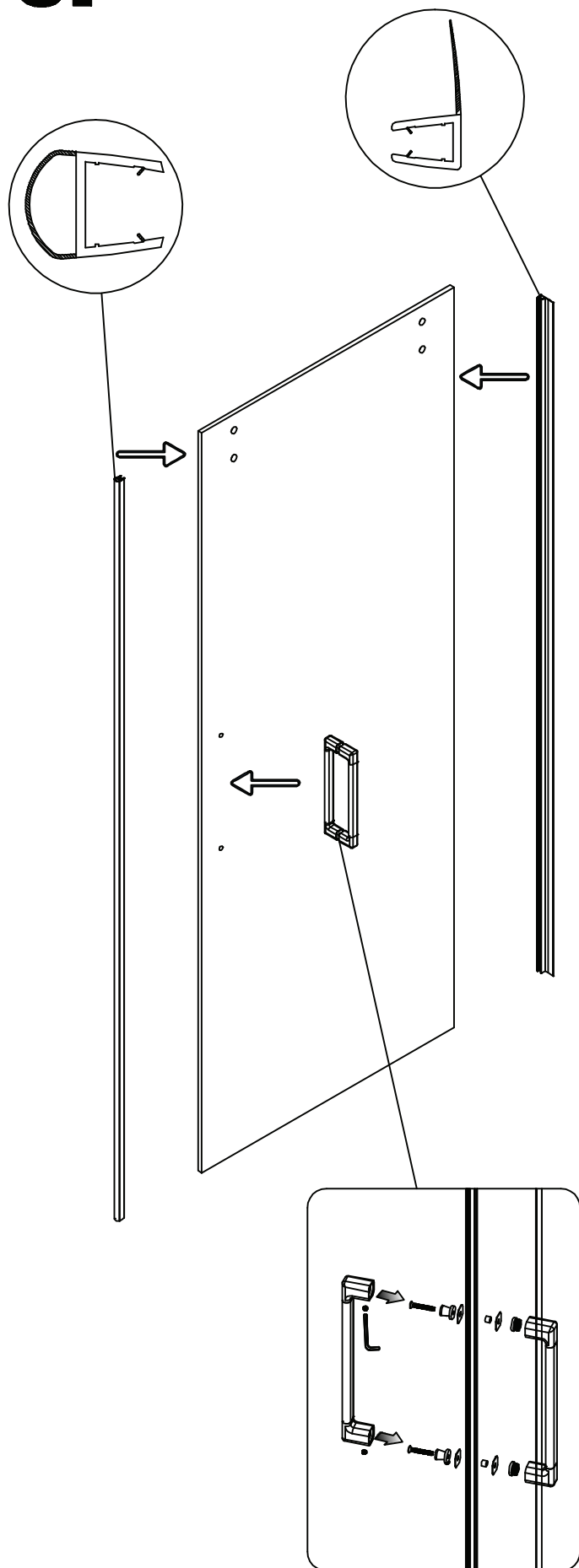

7.

Apply clear silicone on wall side and bottom of return panel if gaskets not used

Wait 24 hours before using.

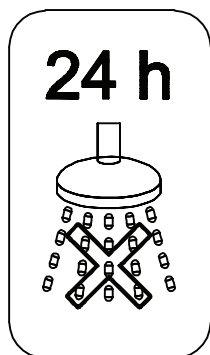
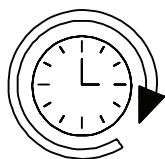

24 h

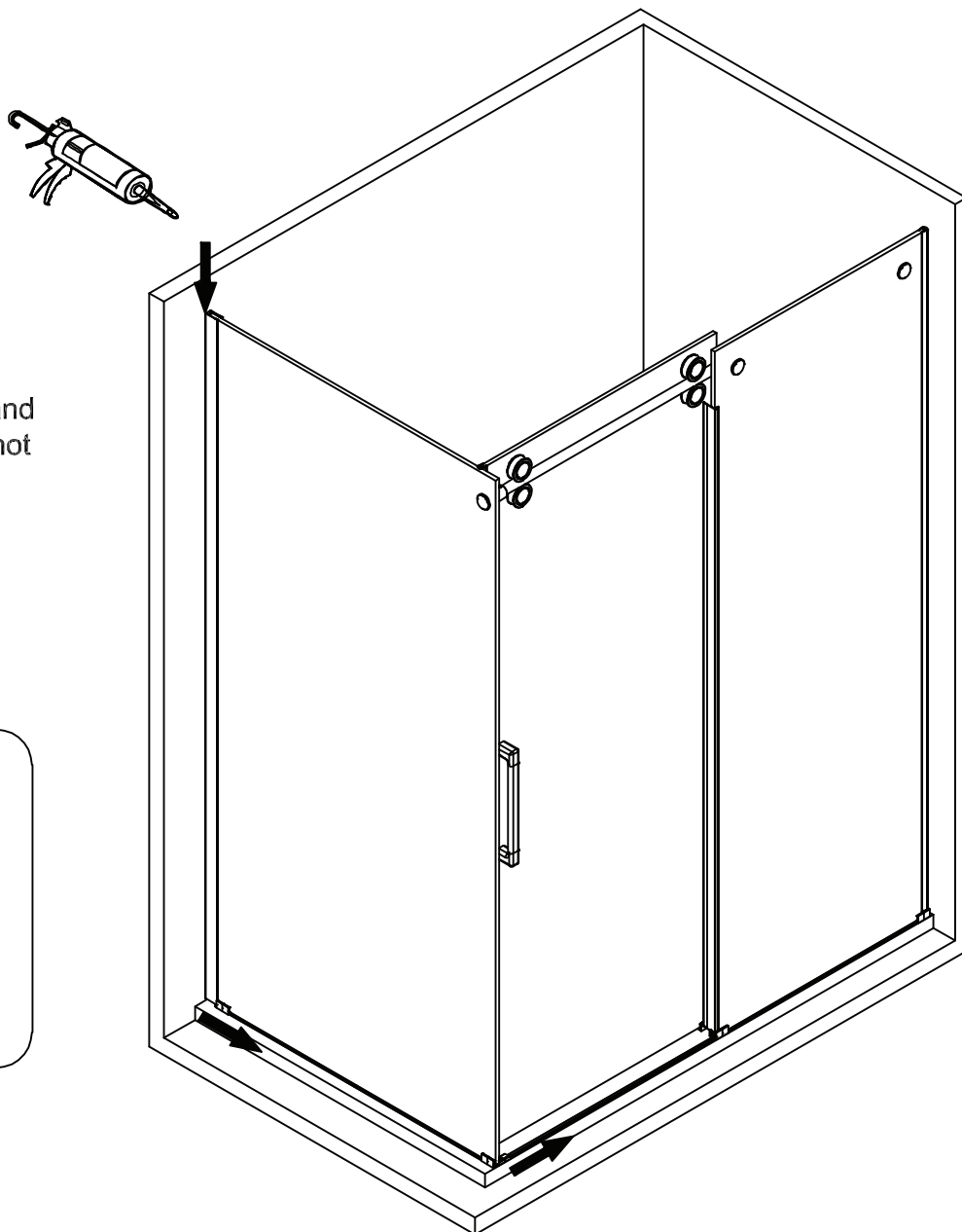



Acritec Industries Corp.

27049 Gloucester Way
Langley, B.C. V4W 3Y3

Tel: 604.607.0856

Fax: 604.607.0857

Email: info@acritec.com

Website: www.acritec.com